



TABLE TALK

AUSTRALASIAN TIMETABLE NEWS

No. 328, December 2019

Published by the Australian Timetable Association

NOTE FROM THE EDITOR

I wish to convey my thanks to Steven Haby for his efforts in covering the entire November edition of *Table Talk*.

RAIL & TRAM NEWS

QUEENSLAND

QR: Inner City lines: 9-10 November

Queensland Rail conducted a shutdown of Brisbane's Inner City lines across the weekend of 9-10 November. Following on from the early October south-west shutdown, another PDF bus timetable was designed by transitgraphics for passengers affected by this shutdown (see bottom of page). Replacement bus route services provided were:

- R296 – Murarrie to Albion (all stops)
- R586 – Yeerongpilly to Bowen Hills (express)
- R591 - Yeerongpilly to Bowen Hills & Albion (all stops)
- R596 – Albion to Corinda (all stops)

Most routes ran at 10-15 minute frequencies during the day. Route 586 express service operated half-hourly.

NEW SOUTH WALES

Sydney Trains: Jan 2020 timetable update

Sydney Trains will introduce an update to its Standard Working Timetable on 5 January 2020. The decommissioning of the T6 Carlingford Line, some additional Hunter Line services and other minor operational updates will form the changes in the document.

A 12-month trial will see two new daily services operate from Singleton to Newcastle Interchange and return. New services are coloured blue in the tables on page 2 (source *Transport for NSW*).

ticket types		useful information	general information	Rail replacement bus services									
<table border="1"> <thead> <tr> <th>Ticket type</th> <th>Where to buy tickets</th> </tr> </thead> <tbody> <tr> <td>TRANSLink</td> <td>Selected go card agents and on the TransLink website</td> </tr> <tr> <td>TransLink go card</td> <td>TransLink bus operators¹ Queensland Rail InterCity² TransLink bus route lines</td> </tr> <tr> <td>TransLink single³</td> <td>✓</td> </tr> <tr> <td>TransLink single⁴</td> <td>✓</td> </tr> </tbody> </table>	Ticket type	Where to buy tickets	TRANSLink	Selected go card agents and on the TransLink website	TransLink go card	TransLink bus operators ¹ Queensland Rail InterCity ² TransLink bus route lines	TransLink single ³	✓	TransLink single ⁴	✓	<p>For up to date public transport information within South East Queensland:</p> <p>translink.com.au</p> <p>Connect to TransLink for:</p> <ul style="list-style-type: none"> • Bus, train, ferry and tram timetables • Route maps • Fares and ticketing information • Journey planning, and real-time information. <p>13 12 30</p> <p>Call TransLink anytime for public transport information including:</p> <ul style="list-style-type: none"> • Timetable, route and fare information • Services in your area • Connecting services • Public transport to special events • Accessibility. <p>The TransLink call centre operates 24 hours a day, seven days a week.</p> <p>The TransLink call centre operates services for non-English speaking callers, and for hearing impaired and speech impaired users.</p> <p>How to use timetables</p> <p>Use the network map to plan your journey, then refer to timetables for travel on the Inner City lines or separate timetables for travel on other lines.</p> <p>Due to unforeseen circumstances, details on this timetable may change.</p> <p>Download the MyTransLink app for the most relevant bus, train, ferry and tram information in the palm of your hand.</p> <p>TRANSLink Visit translink.com.au or call 13 12 30</p>	<p>All customers travelling on TransLink services must be in possession of a valid ticket before boarding. For ticket information, please ask at your local station or call 13 12 30 anytime.</p> <p>While Queensland Rail makes every effort to ensure trains run as scheduled, there can be no guarantee of connections between trains or between train services and bus services.</p> <p>Customer feedback</p> <p>If you have any comments or queries regarding TransLink services, please contact TransLink on 13 12 30 anytime.</p> <p>Lost property</p> <p>Contact Lost Property on 13 16 17 during business hours for items lost on Queensland Rail services. The lost property office is open Monday to Friday 7.30am to 5.00pm and is located at Roma Street station.</p> <p>Public holidays</p> <p>On gazetted public holidays, generally a Sunday timetable operates. On certain major event days (i.e. Australia Day, Anzac Day, sporting and cultural days), special additional services may operate. Christmas Day services operate to a Christmas Day timetable. Prior to travel please visit translink.com.au or call TransLink on 13 12 30 anytime.</p> <p>Special events</p> <p>Contact your local station or TransLink on 13 12 30 anytime for special event services.</p> <p>Text messaging service for customers with disabilities</p> <p>To contact Queensland Rail customers may choose to text 0428 774 636, call 13 16 17, or use the emergency help phone at the station.</p> <p>Customers using mobility devices</p> <p>If you require assistance to board please position yourself near the international symbol of accessibility (white wheelchair on blue background) on the platform. Please indicate to staff that you require assistance and of them know how to assist.</p>	<p>Inner City lines partial closure</p> <p>R296 Murarrie to Albion (Servicing all stations)</p> <p>R586 Yeerongpilly to Bowen Hills (Express service)</p> <p>R591 Yeerongpilly to Bowen Hills & Albion (Servicing all stations)</p> <p>R596 Albion to Corinda (Servicing all stations)</p> <p>TRANSLink QueenslandRail</p> <p>mini network map</p> <p>See inside for complete network map.</p>
Ticket type	Where to buy tickets												
TRANSLink	Selected go card agents and on the TransLink website												
TransLink go card	TransLink bus operators ¹ Queensland Rail InterCity ² TransLink bus route lines												
TransLink single ³	✓												
TransLink single ⁴	✓												
<p>Real-time info about your favourite trip.</p> <p>Free MyTransLink App for iOS and Android</p>		<p><small>© The Table of Queensland (Department of Transport and Main Roads) 2019 Printed November 2019</small></p> <p><small>Queensland Rail Limited ABN 11 130 181 086 - Version 1 - TD19020</small></p>											

Weekday*

Singleton	6.56am	10.40am	1.25pm	3.34pm	7.54pm	9.34pm	9.40pm
Maitland	7.29am	11.13am	1.57pm	4.15pm	8.28pm	10.07pm	10.13pm
Newcastle	8.01am	11.46am	2.21pm	4.48pm	8.59pm	10.39pm	10.45pm

Newcastle	3.18am	8.14am	11.48am	2.24pm	4.29pm	5.59pm	8.24pm
Maitland	3.59am	8.46am	12.12pm	2.56pm	5.02pm	6.32pm	8.56pm
Singleton	4.31am	9.19am	12.42pm	3.28pm	5.34pm	7.04pm	9.28pm

Weekend*

Singleton	7.27am	1.25pm	3.34pm	9.20pm	9.36pm
Maitland	8am	1.57pm	4.17pm	9.53pm	10.10pm
Newcastle	8.32am	2.22pm	4.47pm	10.25pm	10.47pm

*not all stops shown

Newcastle	3.55am	11.51am	2.24pm	5.52pm	8.10pm
Maitland	4.35am	12.14pm	2.56pm	6.25pm	8.42pm
Singleton	5.07am	12.44pm	3.28pm	6.57pm	9.14pm

(Grey signifies the booked Xplorer service.)

CSELR: Tram testing ramps up

Both tram testing and driver training on the upcoming CBD to South East Light Rail (CSELR) ramped up in mid-November with the start of direct timetable testing along the route weeks before most of the line opens in early December. In the CBD, trams have been running every four to six minutes.

CSELR: Services to commence

On the CBD South East Light Rail (CSELR), the L2 CBD to Randwick Line is scheduled to commence operation on Saturday 7th December, pending final testing and commissioning. The new L3 CBD to Kingsford Line is expected to open in March 2020.

CSELR: Training breakdown

On Wednesday 13 November at lunchtime, a tram broke down during testing along George Street at the intersection with Market Street. A power failure along the entire route was the reported reason behind the tram coming to a sudden stop. The tram was moved away 40 minutes later.

Parramatta Light Rail

Works on the Parramatta Light Rail are due to ramp up in 2020 with the decommissioning of the heavy rail T6 Carlingford Line slated for 5th January 2020. Stage One (Westmead to Carlingford) is currently planned to be operational in 2023.

Parramatta Light Rail: Traffic changes

With “enabling works” on the Parramatta Light Rail ramping up, Parramatta’s George Street became a two-way thoroughfare for vehicles from 29 November.

Redfern station

Plans to install lifts at all above-ground platforms at Redfern station will become a reality with the NSW government announcing finalised plans for a \$100 million new Western concourse connecting with Little Eveleigh and Marion streets. Construction is tipped to begin in late 2020. Local residents remain concerned at the impact of the foot traffic on Little Eveleigh Street from the new entrance.

The design shown in the pictures provided (top of page 3) remains subject to further consultation and design processes.



VICTORIA

Metro Trains Melbourne: Timetable changes

The Victorian government announced on 6 November changes to services on the Cranbourne and Pakenham lines with 109 daily services affected. Investigation by Nine News reporter Andrew Lund suggests 93 of those services will see a slowdown in times along the route with the remainder actually seeing a speed-up in times. Other lines will also be set to see some minor adjustments. PTV has cited a desire to increase timetable reliability because of increased dwell times caused by continued population growth.

Also announced on the same day, Southern Cross railway station will open an hour earlier on Sundays to provide more passengers with rail services without having to make their way to Flinders Street station.

The above changes are planned to come into force in early December.

Yarra Trams: New stops

The Victorian government announced on 6 November that two new tram stops would be built on William Street to provide level access with Flagstaff railway station and nearby hospitals and educational institutions.

Yarra Trams: Industrial action

Route 35 City Circle trams did not run across the week from 10 to 16 November due to protected industrial action by Yarra Trams staff over Enterprise Bargaining Agreement (EBA) negotiations. PTV provided advice to passengers of alternate options including routes 30, 70, 75 and 86.

V/Line: New timetable

Following on from the November edition of *Table Talk*, it has been confirmed that V/Line will begin operating new timetables along the Bendigo, Shepparton, Geelong, and Gippsland Lines starting Sunday 1 December. The Ballarat Line's new timetable will begin from Monday 2 December with the opening of Cobblebank station. An overview of changes follows.

- *Bendigo Line*: Some trains to Melbourne from Echuca, Rochester and Elmore depart up to 5 minutes earlier. Some other minor adjustments to rail services between Bendigo and Melbourne.
- *Shepparton Line*: The 12:46 Shepparton to Southern Cross service now departs 20 minutes later, while the Barmah to Shepparton coach route will also see a change.
- *Geelong Line*: From Melbourne, the 18:05 weekday service to Geelong now stops at Deer Park, the 07:13 Saturday train from Warrnambool to Melbourne runs 8 minutes faster along the length of the journey, and the 10:16 train from Geelong to Melbourne becomes permanent.
- *Ballarat Line*: From 2 December, services operating from the new station at Cobblebank, two new weekday PM rail services for Melton, Rockbank, Caroline Springs & Deer Park, and some other minor adjustments to train and coach times.
- *Gippsland Line*: Some trains from Bairnsdale and Traralgon to Melbourne will depart up to 4 minutes earlier, the 08:13 Melbourne to Traralgon service now departs 10 minutes later, and some other minor adjustments to train and coach times.

The remaining lines operated by V/Line will also have their timetables effective from Sunday 1 December with either minor or no changes.

Level crossing removal project

The Victorian government announced on 27 October that four more level crossings are to be removed in 2020 as part of a \$550 million new contract awarded to an alliance of John Holland, Kellogg Brown & Root, and Metro Trains Melbourne. The crossings to be removed are Bell Street, Munro Street, Reynard Street and Moreland Road. Investigative works are already underway.

Two railway stations will also be rebuilt for Metro Trains at Coburg and Moreland. The stations will have a combined 132 bike parking spaces.

SOUTH AUSTRALIA

Adelaide Metro disruption

Over the weekend of 15-17 November, services on the Outer Harbor, Grange and Gawler lines were variously affected to enable night-time testing and commissioning of two activated level crossings at Coglein Street and West Street as part of the Torrens Road to River Torrens Project being undertaken by the T2T Alliance. SA's Department of Planning, Transport and Infrastructure also used this opportunity to complete the Semaphore Road crossing upgrade at Exeter.

Friday 15 November:

- From 19.30, all Outer Harbor services were replaced by buses until last timetabled service.
- From 21.00, Grange line services were replaced by buses until last service.
- On the Gawler line, an additional service departed Gawler Central at 23:55 operating as far as Mawson Lakes.

Saturday 16 November:

- Outer Harbor line replaced by buses only between Glanville and Outer Harbor until 19.30. From 19.30, the entire line was replaced by buses.
- Grange line services replaced by buses after 21.00 until last timetabled service.

Sunday 17 November:

- Outer Harbor line services between Glanville and Outer Harbor replaced by buses all day.

WESTERN AUSTRALIA

Pilbara: Rio Tinto mine road bridge

Construction has begun on a new road bridge on the Pilbara's Great Northern Highway. The construction will see the road run above the proposed Rio Tinto Iron Ore Koodaideri Rail Line. The \$23 million project from Rio Tinto was awarded to a joint venture of Acciona Geotech and Clough Projects. Completion of the project due in June 2020.

NEW ZEALAND

Auckland: New timetable

From 17 November, a timetable update was implemented across Auckland's rail network. Main changes include:

T02 Eastern Line:

- On Mondays to Thursdays, an additional 22:46 service from Britomart through to Manukau. This replicates the established Friday service.

T03 Southern Line:

- The weekday 23:00 Britomart to Otahuhu bus is replaced by a train departing at the same time from Britomart. The train extends all stops through to Papakura.

T04 Western Line:

- An additional weekday service from Henderson (05:10 departure) all stops to Britomart.
- On weekdays, during daytime off-peak, trains from Britomart depart 10 minutes later.
- An additional weekday service departs from Britomart at 19:22 with all following services departing 10 minutes later.
- All weekend and public holiday services from Britomart also depart 10 minutes later.

T05 Onehunga Line:

- Trains depart from stations Onehunga to Ellerslie one minute earlier (until 18:45 on weekends & public holidays, until 19:15 on weekdays – Onehunga time).

Auckland: Construction

Since September 2019, Puhinui station has been closed undergoing major construction in an effort to integrate transport modes for passengers by creating a user-friendly interchange (see bottom of this page and the top of page 5 for artistic designs of the finished interchange). This follows on from previous upgrades in recent years at Panmure, Otahuhu and Manukau stations. Key points about the Puhinui project include:

- Total NZ\$60 million upgrade.
- Anticipated to be complete by March 2021.
- While Puhinui is closed, a free bus service (route 349) is operating to/from Papatoetoe.



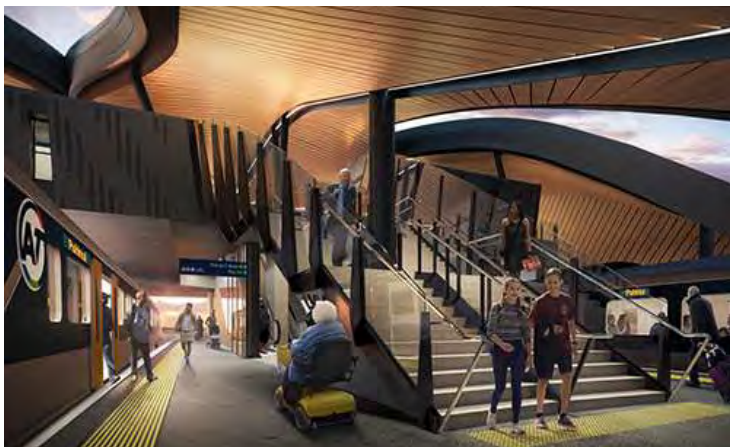

Murrays' new Melbourne service

The national coach operator has commenced an express Melbourne to Canberra service connecting with services to/from Sydney. Two services operate daily departing 09:00 and 22:00 to arrive at 17:00 and 06:00 (next day) respectively from either terminals.

The service commenced on 29 November 2019.

QUEENSLAND

Acquisitions and takeover news

Melbourne based operator Skybus (BTI Pty Ltd) has acquired the businesses of Queensland's Sunbus and Surfside Bus Lines from Australian Transit Systems.

Sunbus operate route and school services in Cairns, Townsville, Rockhampton and the Sunshine Coast while Surfside operates services on the Gold Coast.

The remainder of Australian Transit Systems has been sold to Sealink SA - primarily a ferry operator in South Australia and Queensland.

NEW SOUTH WALES

Changes to Sydney bus routes

The following changes were effective from 17 November:

North-western area:

- *Route 600 Parramatta to Hornsby:* Additional morning peak weekday services from Castle Hill to Parramatta. Additional Saturday morning services from Parramatta to Hornsby and Pennant Hills to Parramatta.
- *601 Parramatta to Rouse Hill:* Sunday service frequency increased from 60 minutes to 30 minutes.

Thanks to Ross Morrison, Hilaire Fraser, Steven Haby, Transport for NSW, Auckland Transport, Adelaide Metro, Victorian government, Nine News reporter Andrew Lund, *Sydney Morning Herald*, Adelaide Metro, WA Government, *Prime Creative*, and *Rail Express* for Rail and Tram news.

BUS & COACH NEWS

NATIONAL

Greyhound changes

Starting from 2 December 2019 until 15 March 2020, an additional evening service will run between Sydney and Brisbane. GX241 departs Sydney at 21:30 to arrive at Brisbane at 10:10 the next day. Stops include Coffs Harbour and Byron Bay.

There will also be an additional daytime service from Brisbane with GX423 departing 09:00 arriving 00:15 the next morning at Sydney Central.

The horrific bushfires on the NSW north coast in November 2019 resulted in a number of services being altered or cancelled due to the closure of the Pacific Highway. Greyhound's website provided regular updates.

Table Talk - December 2019

- *602X Bella Vista to North Sydney*: Morning trips terminate on the Pacific Highway at Walker St. North Sydney, no longer stopping at Victoria Cross in Miller St. Some trips withdrawn.
- *603 Rouse Hill to Parramatta via Glenhaven*: Later weeknight services introduced between Kellyville and Samantha Riley Drive.
- *604 Dural to Parramatta*: Some trips withdrawn.
- *605 North Kellyville to Rouse Hill*: Weekday peak service frequency increased from 30 minutes to 15 minutes.
- *606 Winston Hills to Parramatta*: Route now terminates at Caroline Chisholm Drive, Winston Hills instead of Langdon Rd. Weekday off-peak and evening, and Saturday daytime frequency increased from 60 minutes to 30 minutes. Peak frequency increased from 30 minutes to 15-20 minutes.
- *607N Tallawong to City, 607X Bella Vista to City, and 610N Norwest to City*: Minor timetable changes.
- *610X Kellyville to City*: Frequency reduction between Kellyville and Castle Hill.
- *611 Blacktown to Macquarie Park*: Sunday frequency doubled from 60 minutes to 30 minutes.
- *612X Castle Hill to Milsons Point*: This route will now start and end at North Sydney. Morning trips terminate on the Pacific Highway at Walker St, North Sydney - no longer stopping at Victoria Cross in Miller St. Some trips also fully withdrawn.
- *613X Bella Vista to City*: Minor timetable changes.
- *614X Crestwood to City*: Two additional morning peak services.
- *615X North Kellyville to City*: Frequency between North Kellyville and Acres Road in Kellyville has been reduced from 15/20 minutes to 30 minutes.
- *616X Kellyville Ridge to City*: Minor timetable changes
- *617 Kellyville to Rouse Hill*: This route has been extended to Rouse Hill metro station.
- *619 Castle Hill to Macquarie Park*: This has become a peak-only service.
- *620X Dural to City*: Extra afternoon shoulder peak and evening services.
- *620N City to Cherrybrook, 622 Dural to Milsons Point, and 625 Pennant Hills to Parramatta*: Minor timetable changes.
- *626 Kellyville to Pennant Hills*: Route now operates via New Line Rd, County Drive & John Rd direct to Cherrybrook metro station. Peak frequency increased to 15 minutes between Cherrybrook Shops and Cherrybrook station. Service frequency on Saturdays has also increased to 30 minutes between Castle Hill and Pennant Hills.
- *632 Rouse Hill to Pennant Hills*: Weekday off-peak frequency increased from 60 minutes to 30 minutes.
- *633 Rouse Hill to Pennant Hills*: Weekday morning and afternoon peak-hour service frequency doubled from 30 minutes to 15 minutes between James Mileham Dr (Kellyville) and Castle Hill. Later services also operate to and from Pennant Hills on weeknights and Saturday nights.
- *635 Castle Hill to Beecroft via West Pennant Hills*: Adjusted to operate via Cherrybrook Village shops and David Rd. Minor timetable adjustments introduced during weekday peak periods. Later weeknight and new weekend services also introduced.
- *642X Dural to City*: Services no longer operate via John Road. New earlier and later afternoon peak, and evening services introduced. Services now departing the City between around 2.30pm and 9.00pm. New weekday off-peak and late evening services operate between Round Corner Dural and Cherrybrook metro station.
- *651 Rouse Hill to Epping*: Weekday off-peak service frequency doubled between Castle Hill and Epping (now half-hourly).
- *652X West Pennant Hills to City*: All trips extended to commence from or finish at Highs Rd / Castle Hill Rd.
- *660 Parramatta to Castlewood, 661 Parramatta to Blacktown, 662 Parramatta to Castle Hill, 663 Parramatta to Rouse Hill, 664 Parramatta to Rouse Hill, 665 Parramatta to Rouse Hill, 706 Parramatta to Blacktown, 714 Seven Hills to Norwest, and 715 Seven Hills to Rouse Hill*: Minor timetable changes with some additional services on routes 662,664 and 715.
- *747 Rouse Hill to Marsden Park*: Weekday peak frequency increased to 30 minutes.
- *S8 Wentworthville to Constitution Hill*: This previous 'Shopper Hopper' route is now renumbered as 709.

Northern Beaches and North Shore:

- **Route B1 City to Mona Vale:** Additional morning peak services from Dee Why or Warringah Mall to City.
- **136 Chatswood to Manly:** Minor timetable changes.
- **142 Manly to Allambie:** Route extended to Skyline Shops.
- **143/4 Manly to Chatswood, and 146 Manly to Wheeler Heights:** Minor timetable changes.
- **155 Bayview Garden Village to Narrabeen:** Route extended to Northern Beaches Hospital in Frenchs Forest via Wakehurst Parkway.
- **169 City to Manly, 178 City to Cromer Heights, 180 City to Collaroy Plateau, 199 Manly to Palm Beach, 230 Milsons Point to Mosman Wharf, 246 City to Balmoral Heights, 247 City to Mosman Junction, E54 Milsons Point to Mona Vale, E60 Mona Vale to Chatswood, and E69 City to Manly:** Minor timetable changes.

Eastern Suburbs:

- **Routes 323 North Bondi to Edgecliff, and 343 Kingsford to Chatswood:** Minor timetable changes.

There are also minor timetables changes for Transit Systems routes in both South-West Sydney (Parramatta to Liverpool) and the Inner West.

635 Beecroft to Castle Hill via West Pennant Hills

Valid from: 17 Nov 2019
Creation date: 01 Nov 2019
NOTE: Information is correct on date of download.

Monday to Friday	6:30	6:45	7:00	7:15	7:30	7:45	8:00
Beecroft Station	05:30	06:00	06:30	06:45	07:00	07:15	07:30
Beecroft Public School, Copeland Rd, Beecroft	05:30	06:00	06:30	06:45	07:01	07:16	07:31
Oratava Ave after Dehlsen Ave, West Pennant Hills	05:38	06:08	06:38	06:53	07:09	07:24	07:39
Taylor St before Highs Rd, West Pennant Hills	05:43	06:13	06:43	06:58	07:14	07:29	07:44
Blacks Rd opp Millers Way, West Pennant Hills	05:46	06:16	06:46	07:01	07:17	07:32	07:47
Coonara Ave opp Plumtree Ct, West Pennant Hills	05:50	06:20	06:50	07:05	07:21	07:36	07:51
Cherrybrook Station	05:54	06:24	06:54	07:10	07:26	07:42	07:57
Shepherds Dr opp Cherrybrook Shops, Cherrybrook	06:02	06:32	07:02	-	07:36	-	08:08
James Henty Dr after New Line Rd, Dural	06:07	06:37	07:08	-	07:42	-	08:15
David Rd at Milford Gr, Castle Hill	06:13	06:43	07:14	-	07:49	-	08:22
Castle Hill Station	06:26	06:56	07:27	-	08:03	-	08:36

635 Castle Hill to Beecroft via West Pennant Hills

How to use this timetable
This timetable provides a snapshot of service information in 24-hour time (e.g. 5am = 05:00, 5pm = 17:00). Information contained in this timetable is subject to change without notice. Please note that timetables do not include minor stops, additional trips for special events, short term changes, holiday timetable changes, real-time information or any disruption alerts.

For the most up-to-date times, use the Trip Planner or Departures on transportnsw.info

Real-time planning
You can plan your trip with real-time information using the Trip Planner or Departures on transportnsw.info or by downloading travel apps on your smartphone or tablet. The Trip Planner, Departures and travel apps offer various features:

- favourite your regular trips
- see where your service is on the route
- get estimated pick up and arrival times
- receive service updates
- find nearby stations, stops, wharves and routes
- check accessibility information

Find the latest apps at transportnsw.info/apps

Accessible services
All new buses are wheelchair-accessible with low-level floors and space for wheelchairs, prams or strollers. Look for the **B** symbol in this timetable. Some older buses may not have all the features you need. There will be more accessible services as older buses are replaced.

Who is providing my bus services?
The bus services shown in this timetable are run by Hillsbus.

Fares
In Sydney and surrounding regions, fares are based on:

- the distance you travel from tap on to tap off
- the mode of transport you choose
- whether you're eligible for a concession fare or free travel
- any Opal benefits such as discounts and capped fares that apply

You can use an Opal card or a contactless payment to pay for your travel.

Opal cards
An Opal card is a smartcard you keep and reuse. Add value before you travel and tap on and tap off to pay your fares throughout Sydney, the Blue Mountains, Central Coast, the Hunter and the Illawarra.

Which Opal card is right for you?
Adult - Customers 16 years and over who are not entitled to any concessions and normally pay full fare.
Child/Youth - For customers aged 4-15 (inclusive), or customers 16 years or older who hold a NSW/ACT Senior Secondary Student Concession Card.
Gold Senior/Pensioner - For eligible NSW and interstate seniors, pensioners, war widows/widowers and asylum seekers.
Concession - For eligible tertiary students, job seekers, apprentices and trainees.

How to get an Opal card
You can get an Adult or Child/Youth Opal card over the counter at Opal retailers that display the Opal sign. To find your nearest retailer visit transportnsw.info/opal.
If you are eligible to travel with concession fares you can apply for a Gold Senior/Pensioner or Concession Opal card online. Visit transportnsw.info/opal for more information.

Contactless payments
If you have an American Express, Mastercard, Visa card or linked device, you can use it to pay for all public transport on the Opal network. Just make sure to tap on and tap off at Opal readers at the beginning and end of your trip.
Always separate your cards when you tap on and tap off so your preferred card is charged.
You will receive the same travel benefits of an Adult Opal card when you tap on and tap off consistently with the same credit card, debit card or linked device. This includes daily, weekly and Sunday travel caps, and a \$2 transfer discount when you change between metro/train, ferry, bus or light rail services within 60 minutes. Adult Opal fare pricing applies.
Find out more at transportnsw.info/contactless

Explanation of definitions and symbols
B Wheelchair Accessible
B Diverts to Beecroft PS via Copeland (R) York (L) Hannah (L) Cardinal (R) Copeland (R) Pennant Hills (L) Aiken then as normal. Omits stops on Hannah St and Copeland Rd (School days)

Extract of amended route 635 (Transport for NSW)

Table Talk - December 2019

Extract of amended route 635 (Transport for NSW)

626 Pennant Hills to Kellyville Station via Cherrybrook

Valid from: 17 Nov 2019
Creation date: 01 Nov 2019
NOTE: Information is correct on date of download.

Monday to Friday	6:30	6:45	7:00	7:15	7:30	7:45	8:00
Pennant Hills Station	-	05:30	-	06:00	-	06:30	-
Cherrybrook Public School, New Line Rd, Cherrybrook	-	05:36	-	06:06	-	06:37	-
Cherrybrook Shops, Shepherds Dr, Cherrybrook	05:15	05:41	05:55	06:11	06:25	06:42	07:00
Purchase Rd at Forest Glen, Cherrybrook	05:23	05:48	06:04	06:19	06:34	06:51	07:10
Cherrybrook Station	05:29	05:54	06:10	06:25	06:40	06:57	07:17
Castle Hill Station	-	06:01	-	06:32	-	07:05	-
Hills Showground Station	-	06:07	-	06:39	-	07:12	-
Centenary of ANZAC Reserve, Green Rd, Castle Hill	-	06:12	-	06:44	-	07:17	-
Acres Rd at Windsor Rd, Kellyville	-	06:20	-	06:52	-	07:26	-
Kellyville Station	-	06:29	-	07:01	-	07:36	-

Extract of new route 626 (Transport for NSW)

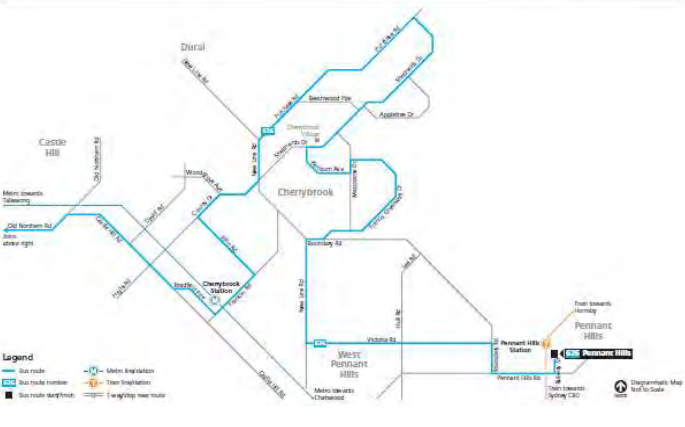
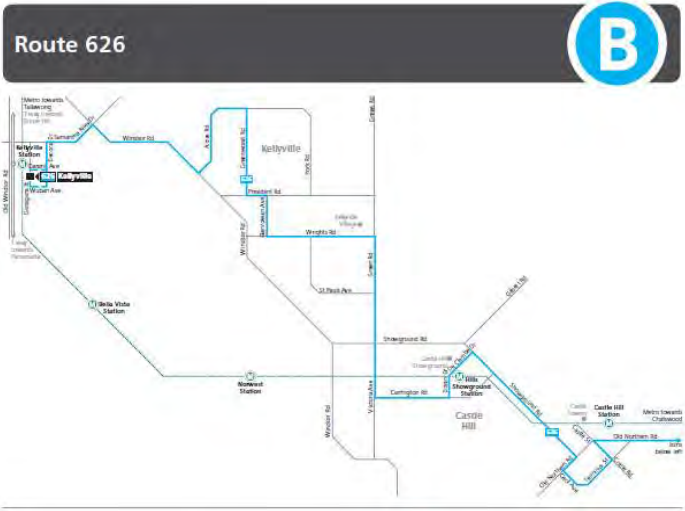

Extract of new route 626 (Transport for NSW)

The second service departs Dubbo at 10:00 operating via Tomingley, Peak Hill, Parks and Manildra to arrive at Orange 12:45.

VICTORIA

New bus routes from 1 December

The following new routes will commence from the above date:

- **Route 525 Donnybrook to Craigieburn via Mickleham:** Operated by Dyson's. The frequencies and route details were not available at the time of publication.
- **Route 444 Rockbank station to Aintree:** Operated by Sita Bus Lines this short route services the new estate which has been constructed on the northern side of the Western Highway. A 40 minute off-peak service daily will operate with a 30 minute peak service. A one way trip will take seven minutes.
- **Route 454 Cobblebank station to Melton station:** Designed to serve the new Cobblebank railway station, this service operated by Sita Bus Lines runs every 40 minutes daily.

More 'on demand' services cease

Busways' Coee trial that commenced in January 2019 ceased as of Friday 20 September. The trial used existing school buses between runs to provide an 'on demand' service to isolated areas of Aldaville, Coramba, Crossmaglen and Thrumster.

Additional TrainLink trial services

In the 2019/2020 NSW budget, 13 new trial TrainLink coach services were announced.

A six month trial between Wagga Wagga and Canberra/Queanbeyan operated by Swan Hill Bus Lines has since commenced. On Mondays and Fridays, the service departs Wagga at 07:00 running via Gundagai to arrive at Queanbeyan 10:55. On Tuesdays, Thursdays and Saturdays, it departs Wagga at 07:00 running via Junee and Cootamundra to arrive at Queanbeyan 11:20. Return services depart Queanbeyan at 16:30 arriving Wagga at 20:25 (via Gundagai) and 20:50 via Junee.

Similar services via Junee were trialled by Fearn's and Makeham in the past but were not profitable.

Another trial service commenced on 8 April 2019 also operated by Swan Hill Bus Lines running on two routes from Dubbo. On Mondays, Wednesdays, Fridays and Sundays, a service departs Bathurst at 06:15 running via Wellington and Orange to arrive at Dubbo 09:00.

Table Talk - December 2019

SITA		Route 444 Rockbank Station		Service operates from 02.12.2019 until further notice	
Monday to Friday					
Wheelchair Accessible Services	Morning (am) / Afternoon (pm)	am	pm	am	pm
Frontier Ave/Timberlog Pde (Rockbank)	0:07	0:37	7:08	7:28	8:08
Frontier Ave/Fields St (Aintree)	0:08	0:38	7:09	7:29	8:09
Goldsmith Way/Frontier Ave (Aintree)	0:08	0:38	7:10	7:40	8:10
Frontier Ave/Taylor Rd (Aintree)	0:10	0:40	7:11	7:41	8:11
Quarry Rd/Taylor Rd (Aintree)	0:10	0:40	7:11	7:41	8:11
Woodlea Blvd/Lakes Rd (Aintree)	0:11	0:41	7:12	7:42	8:12
Rockbank Station (Rockbank)	0:14	0:44	7:15	7:45	8:15
Monday to Friday					
Wheelchair Accessible Services	Morning (am) / Afternoon (pm)	am	pm	am	pm
Frontier Ave/Timberlog Pde (Rockbank)	4:02	4:28	4:58	5:28	6:53
Frontier Ave/Fields St (Aintree)	4:03	4:29	5:00	5:29	6:53
Goldsmith Way/Frontier Ave (Aintree)	4:04	4:30	5:01	5:30	6:54
Frontier Ave/Taylor Rd (Aintree)	4:05	4:31	5:02	5:31	6:55
Quarry Rd/Taylor Rd (Aintree)	4:05	4:31	5:02	5:31	6:55
Woodlea Blvd/Lakes Rd (Aintree)	4:06	4:32	5:03	5:32	6:56
Rockbank Station (Rockbank)	4:09	4:35	5:06	5:36	6:59
Saturday					
Wheelchair Accessible Services	Morning (am) / Afternoon (pm)	am	pm	am	pm
Frontier Ave/Timberlog Pde (Rockbank)	6:53	7:28	8:58	9:28	10:58
Frontier Ave/Fields St (Aintree)	6:54	7:29	8:59	9:29	10:59
Goldsmith Way/Frontier Ave (Aintree)	6:55	8:00	9:00	10:00	11:00
Frontier Ave/Taylor Rd (Aintree)	6:56	8:01	9:01	10:01	11:01
Quarry Rd/Taylor Rd (Aintree)	6:56	8:01	9:01	10:01	11:01
Woodlea Blvd/Lakes Rd (Aintree)	6:57	8:02	9:02	10:02	11:02
Rockbank Station (Rockbank)	7:00	8:05	9:05	10:05	11:05
Sunday					
Wheelchair Accessible Services	Morning (am) / Afternoon (pm)	am	pm	am	pm
Frontier Ave/Timberlog Pde (Rockbank)	6:53	8:29	9:58	10:58	11:58
Frontier Ave/Fields St (Aintree)	6:54	8:30	9:59	10:59	11:59
Goldsmith Way/Frontier Ave (Aintree)	6:55	8:31	10:00	11:00	12:00
Frontier Ave/Taylor Rd (Aintree)	6:56	8:32	10:01	11:01	12:01
Quarry Rd/Taylor Rd (Aintree)	6:56	8:32	10:01	11:01	12:01
Woodlea Blvd/Lakes Rd (Aintree)	6:57	8:33	10:02	11:02	12:02
Rockbank Station (Rockbank)	7:00	8:36	10:05	11:05	12:05
Service Information					
= Wheelchair Accession					

Extract of the new 444 timetable (PTV)

Minor changes from 1 December

The following bus routes will have minor timetable changes effective from 1 December to better reflect local traffic conditions:

- **Route 427 Sunshine station to Sunshine West via Forrest.**

- Route 428 Sunshine station to Sunshine West via Wright St.
- Route 453 Melton to Melton station via Brookfield.
- Route 455 Micasa Rise – Roslyn Park – Melton station.
- *Route 456 Melton to Sunshine:* All trips will now service Rockbank station (rather than only alternating trips).
- Route 457 Melton to Melton station via Melton West.
- Route 458 Kurunjang to Melton station.
- *Route 459 Melton to Arnolds Creek:* Will be altered to reduce duplication on the southern portion of the route and will be extended further north along Claret Ash Blvd.
- Route 471 Williamstown to Sunshine station via Newport & Altona Gate SC.
- Route 472 Williamstown to Moonee Ponds via Footscray.

Adjustments to Echuca to Barmah trial

From 31 October, trial bus route 8 started running to an altered timetable with trips departing an hour later. This service runs every second Thursday and is run by Dyson's.

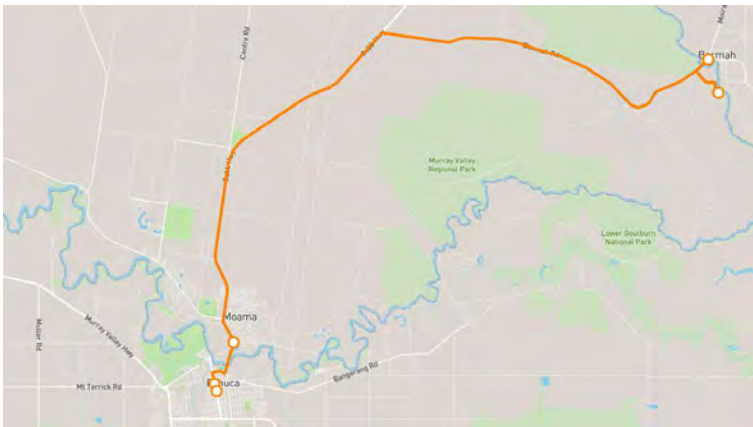

Extract of map of route 8 Echuca – Barmah (PTV)

Dysons Moama		PT	
Route Barmah 8		Echuca	
Service operates from 14.11.2019 until 14.11.2019			
Monday to Friday			
Service Information	H	H	
Morning (AM) / Afternoon (PM)	am	pm	
Barmah (Hickling St) (Barmah)	10:55	3:15	
Cummaragulla/Tongala Ave (Moama (NSW))	10:40	3:20	
Murray River (Cannon/Cook Hwy) (Moama (NSW))	11:10	3:50	
Platachian St/High St (Echuca)	11:15	3:55	
Darling St/High St (Echuca)	11:15	3:55	
Service Information			
H = Service operates every 2nd Thursday - Visit gov.vic.gov.au for the dates.			

Extract of timetable for route 8 (PTV)

Volgren's 5,000th bus

Volgren celebrated the finished build of its 5,000th bus at its Dandenong factory in mid-November. A low-floor Optimus, it was delivered to Ventura Bus Lines. Volgren and Ventura also arranged for the first bus manufactured by Volgren at Dandenong to be present at a ceremony.

The bus is expected to be introduced into regular route service for Ventura.

TASMANIA

Forthcoming North West service changes

As part of the significant upgrade to bus services in the North West coastal area of Tasmania, the following service improvements are planned to be introduced at a date to be fixed:

- A new express bus connecting Burnie, Ulverstone, Penguin and Devonport with provision of improved connections to Launceston and southern destinations such as Hobart. The service will operate hourly on weekdays and two-hourly on weekends. This will replace the poorly-used Hospital bus between Latrobe and Burnie.
- Sunday bus services will be introduced in Smithton, Wynyard, Latrobe, Port Sorell, Sheffield and key routes in both Burnie and Devonport.

SOUTH AUSTRALIA

Adelaide bus patronage declines

Lobbyists say that public transport policies are discouraging patronage in Adelaide after figures released through Freedom of Information (FOI) requests uncovered a decline in bus patronage in the first six months of 2019.

SA State Opposition Leader Peter Malinauskas reported that Adelaide commuters took 231,287 fewer bus journeys in the first six months of this year compared to the same period in 2018. Total journey numbers declined to 25,145,642 trips compared to last year's 25,376,929.

In last year's state budget, the SA government announced it would save \$15 million by rationalising under-used bus routes, a move the local union said reduced 1,170 bus routes.

Transport Minister Stephan Knoll claimed the lions share of declines in journeys occurred throughout January (190,000) where the Christmas timetable was extended into the first week of the month. The bus route changes came to effect on 27 January.

People for Public Transport president Josephine Buckhorn said her not-for-profit organisation had been

receiving a lot of complaints from people about buses. Ms Buckhorn said frequency of buses and their lack of convenience — including long distances between bus stops on some routes — were stopping people from using local bus services.

WESTERN AUSTRALIA

Perth changes

Proposed changes to Wanneroo Rd and Mirrabooka area services are outlined as follows:

- *Route 344 Morley to Warwick via Ballajura:* Minor timetable changes.
- *355 Whitfords to Ellenbrook Central:* Now operates via Wangara Industrial Area replacing route 469.
- *Whitfords to Wangara.* Gnangara Rd is now served by route 376 Mirrabooka-Landsdale via Mirrabooka Av which has been extended to Whitfords.
- *371 Morley to Warwick via Mirrabooka:* Saturday service frequency has increased from 30 minutes to a bus every 15 minutes.
- *374 Mirrabooka to Whitfords via Girrawheen Ave:* New service that replaces routes 365 *Mirrabooka to Kingsway City via Girrawheen Ave* and 352 *Landsdale to Whitfords through Madeley*.
- *375 Mirrabooka to Alexander Heights via Finchley Cr:* New service that replaces routes 372 *Mirrabooka-Marangaroo via Finchley Cr* and 377 *Mirrabooka-Alexander Heights along Jefferson Dr*.
- *376 Mirrabooka to Landsdale via Mirrabooka Ave:* Route extended to Whitfords via Gnangara Rd to replace that section of route 355.
- *377 Mirrabooka to Alexander Heights via Koondoola Av:* Jefferson Dr now served by route 375.
- *378 Mirrabooka to Alexander Heights via Alexander Dr:* Some trips discontinued.
- *384 Perth to Mirrabooka via Wanneroo Rd:* Additional weekday trips.
- *385 Perth to Kingsway City (Limited Stops) and 386 Perth to Kingsway City:* Now serves Girrawheen Av and Highclere Blvd. Culloton Cr continues to be served by route 371. Giralt Rd now served by new route 448.
- Saturday services on route 386 also increased from hourly to a service every 30 minutes.

- *387 Perth to Warwick via Balcatta Rd:* Saturday short trips between Northlands Plaza Shopping Centre and Warwick discontinued.
- *388 Perth to Warwick via Beach Rd:* Saturday services decreased from 30 minutes to 60 minutes.
- *389 Perth to Wanneroo:* Time changes.
- *448 Kingsway City to Warwick:* New service replacing routes 365, 385 and 386 along Giralt Rd.
- *Route 449 Malaga to Warwick via Beach Rd:* A new service.
- *Route 450 Lansdale to Warwick:* Saturday services increased from 60 minutes to 30 minutes.

In summary, brand new routes introduced are 374, 375, 448 and 449. Routes 352, 365, 372 and 469 will be withdrawn. Routes 355, 376, 377, 385 and 386 will be altered while routes 344, 371, 378, 384, 387, 388, 389 and 450 will have timetable changes.

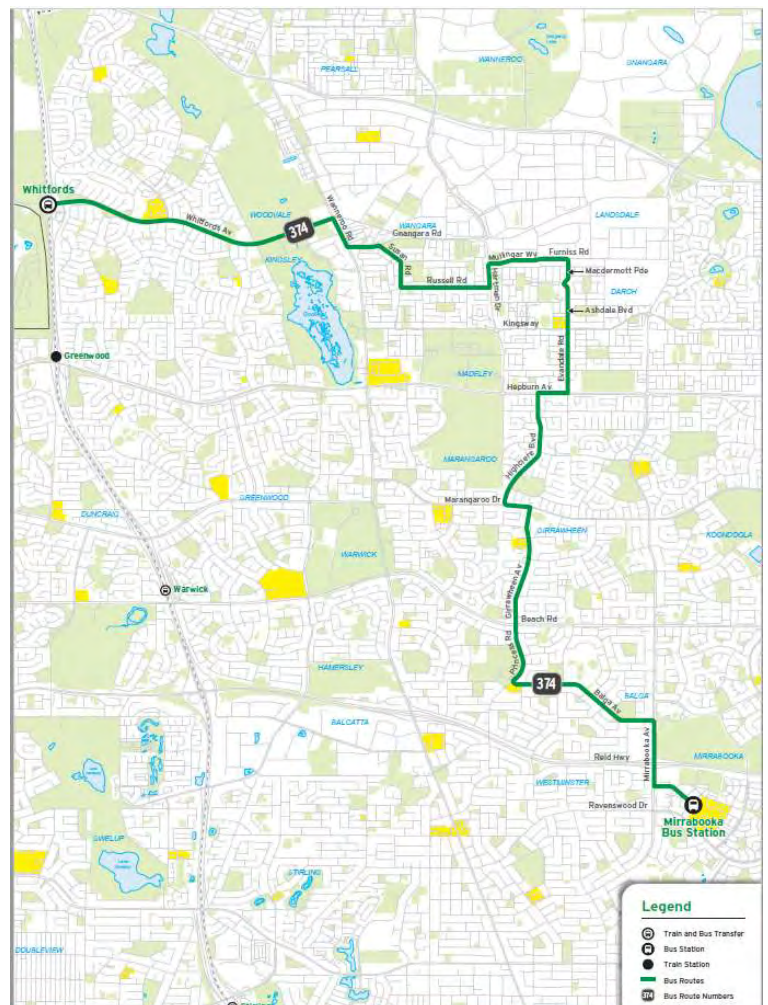

Map of proposed new route 374 (TransPerth)

FERRY & SHIP NEWS

VICTORIA

New Geelong ferry

From 2 December 2019, a new Geelong to Docklands service will commence. The service will be operated by Port Phillip Ferries, which also runs the Portarlington service. Times on the ferry service are hamstrung by speed restrictions along the Yarra River.

TASMANIA

Bass Island Line, King Island

After a period of review, the Tasmanian government has decided to retain the 'BIL' King Island service in long-term TasPorts ownership. Reportedly, none of the market participants could adequately demonstrate a commitment to improvements to BIL service without substantial ongoing involvement from TasPorts. The ship *John Duigan* currently operates a weekly Devonport – Grassy – Geelong – Grassy – Devonport rotation.

Thanks to Paul Brown, Hilaire Fraser, Steven Haby, ABC News, The Age, AdelaideNow, Bus and Coach Society of Victoria, *The Log* journal, Richard Talbot, Stuff and Metlink for Bus, and Ferry & Ship news.

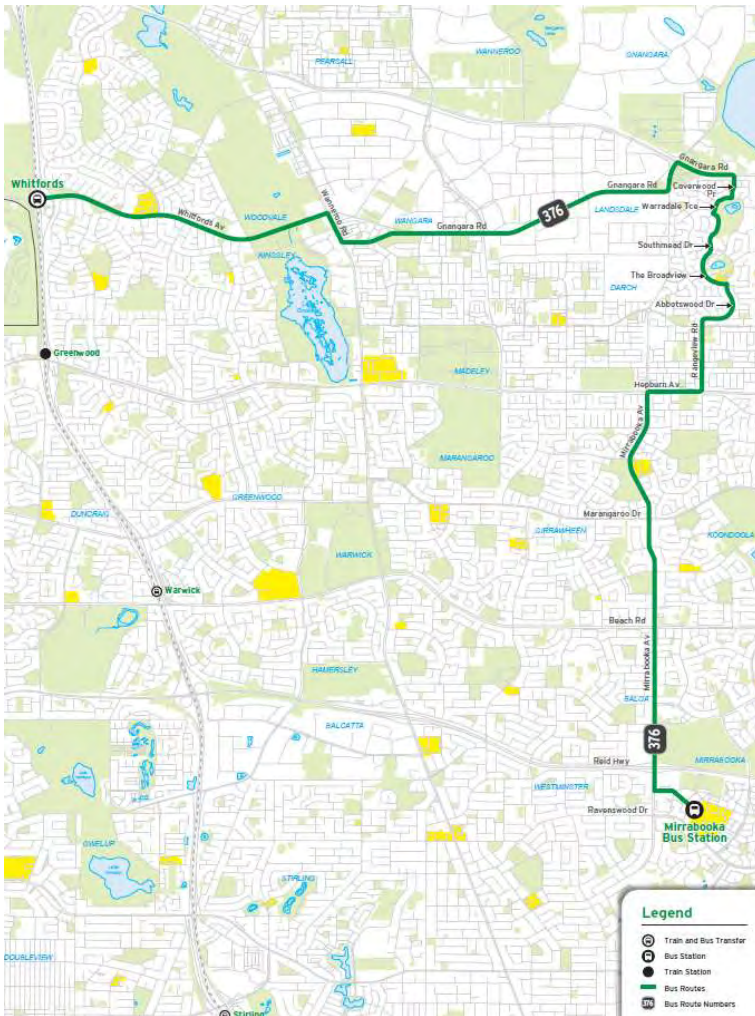

Map showing proposed new route 376 (TransPerth)

NEW ZEALAND

Wellington bus driver shortage

Numerous peak-hour bus services across Wellington are cancelled every day due to an ongoing shortage of drivers which has hit the city for over a year.

Tramways Union secretary Kevin O'Sullivan blamed the July 2018 timetable changes calling them "almost irreversible".

In February, NZ Bus cancelled 21 bus trips due to the shortage. From late August, operator Tranzurban added to the tally with 25 cancellations of their own. The list of daily 'planned cancellations' remains at 46.

In early September, NZ Bus recruited six drivers from the Philippines on one-year work permits in an effort to stem the increasing cancellations as the debate continues over how to end the shortage.

Taxi vans are also reportedly being used on several routes in an effort to minimise the number of regular trips being cancelled.

AIR NEWS

DOMESTIC

Virgin route changes

Following its recent internal review, Virgin Australia has announced it will reduce or shut some of its domestic routes in the coming three months. The Perth to Canberra and Perth to Gold Coast routes will finish in December and January respectively, while Sydney to Tamworth flights will be halved to six per week.

Velocity frequent flyer program

Virgin Australia has confirmed it plans to buy back the 35 per cent in the Velocity frequent flyer program it sold in 2014 to Affinity Equity Partners. Virgin will be paying double the price it initially sold the stake for.

Tigerair route cancellations

Tigerair, the low-price carrier owned by Virgin Australia, will soon stop their Brisbane to Darwin, Brisbane to Adelaide and Sydney to Proserpine flights.

Rex and Dubbo Reg. Council square-off

In an unprecedented move, Regional Express (Rex) sent letters to 16,000 local households across Dubbo in October stating that 13 per cent increases to charges at Dubbo Airport by Dubbo Regional Council would not only hurt customers but also threaten future flights in/out of Dubbo Airport.

Rex also threatened to relocate flights to/from Dubbo to other regional centres in New South Wales in response to the increases.

This followed discussions in previous months between the council and Rex to decrease ticket costs which were declined by council because it did not want local ratepayers to be burdened with partially subsidising air travel.

The two parties will meet again in December.

INTERNATIONAL

Qantas route changes

Qantas announced on 12 November that it would cease operating direct flights between Sydney and Beijing due to a drop in patronage and increased competition on the route from Chinese-based state carriers. Continued political protests in Hong Kong have seen bookings on flights to/from Australia slump in recent weeks which may impact flight schedules in the short term.

Virgin route changes

In February, Virgin Australia will suspend daily flights between Melbourne and Hong Kong after only 19 months of operation. The Airbus A330 aircraft from this route will be reallocated to provide Virgin's new daily flights between Brisbane and Tokyo starting in March. Virgin will continue to operate Hong Kong flights from Sydney. Melbourne to Bali flights will also be added.

From 29 April, Virgin will also stop operating its Sydney to Christchurch route. Some time in 2020, flights between Sydney and Auckland will also be reduced by 25 per cent from 19 flights per week to 14.

Air NZ route changes

Air New Zealand has announced it will launch non-stop flights between Auckland and New York from October 2020. It plans to use the 787-9 Dreamliner on the route.

The airliner also announced on the same day that it will be cancelling its international flagship Los Angeles to London route after 37 years. This will see the removal of its 130-strong London-based crew once the route ceases, also in October 2020.

Air NZ Acting CEO, Jeff McDowell, has cited strong visitor growth to New Zealand from North America and competitive pressures across the Atlantic for the related decisions.

Thanks to Paul Brown, Steven Haby, New Zealand Herald, ABC News and Executive Traveller for Air news.



About *Table Talk*

Print ISSN 1038-3697, Online ISSN 2209-718X.

Table Talk is a monthly publication produced by the Australian Timetable Association Inc. (Registration No. A0043673H) as a journal of record covering recent timetable news items. The ATA also publishes *The Times* covering timetable history and analysis. Contributions are invited and very welcome. Please send these to the appropriate Editor. All times listed in *Table Talk* are in 24-hour time, unless specifically stated otherwise. ABN 74248483468.

We welcome contributions to *Table Talk* at all times.

Editor, Rail, Tram, Air and Ferry (Interim): Chris Pandilovski, tabletalk@timetable.org.au.

Editor, Bus: Steven Haby, busnews@timetable.org.au.

Production and Mailout: Geoff and Judy Lambert.

Proofreaders: Agnes Boskovitz, David Cranney and Geoff Hassall.

Original material appearing in *Table Talk* may be reproduced in other publications provided that kind acknowledgement is made.

Membership of the Australian Timetable Association includes monthly copies of *The Times*, *Table Talk*, the ATA Distribution List of timetables, and Auction catalogues. The membership fee is Adult \$60, Student \$36, Family \$5 pa. All membership enquiries should be directed to our Membership Officer, Len Regan, at membership@timetable.org.au.

Back issues of *Table Talk* are available on our website, www.timetable.org.au, after two months from print publication.

Table Talk Newswire is an advance monthly email of Rail News. To obtain this, contact the Rail Editor.